



MEDOWIE VILLAGE DEVELOPMENT

ARCHITECTURAL DRAWING LIST

NO.	TITLE	REV
SK00	COVERSHEET	G
SK02A	GROUND FLOOR PLAN	E
SK02B	UNDERCROFT PLAN	D
SK02C	SECTIONS	B
SK02D	PERSPECTIVE	B
SK02E	FOOTPATH PLAN	A

COMMERCIAL BUILDING AREAS

SUPERMARKET	1,613 m²
RETAIL (GROUND FLOOR)	2,670 m²
CAFE / FAST FOOD	840 m²
COMMERCIAL (LEVEL 1)	2,495 m²
EARLY LEARNING CENTRE	770 m²
OFFICE / PUBLIC AMENITIES	325 m²
TOTAL BUILT AREA	8,713 m²

CARPARKING SPACES	345
--------------------------	------------

RESIDENTIAL AREA YIELD

DETACHED (450 SQM LOT)	11 DWELLINGS
DUAL OCCUPANCY (600 SQM LOT)	20 DWELLINGS
TOWNHOUSES/ VILLA (SQM LOT VARIES)	35 DWELLINGS
APARTMENTS (SQM LOT VARIES)	42 DWELLINGS
TOTAL DWELLINGS	108

DEVELOPABLE SITE AREA:

COMMERCIAL	19.240SQM
EARLY EDUCATION	2.970 SQM
RESIDENTIAL	26.455 SQM

BUILDING AND SITE INFORMATION

ADDRESS:
46 TO 54 FERODALE ROAD, MEDOWIE
LOTS 3 - 8 DP 243518

CLIENT:
VC MANAGEMENT



MEDOWIE COMMERICAL VILLAGE DEVELOPMENT

GROUND FLOOR

LEGEND

- RETAIL AND COMMERCIAL

SUPERMARKET AND WAREHOUSE

AMENITIES AND VILLAGE OFFICE

FAST FOOD OUTLET

CAFE
- EARLY EDUCATION CENTRE

RESIDENTIAL 450 sqm²

DUAL OCCUPANCY 600 sqm²

TOWNHOUSES / VILLA sqm varies

APARTMENT BLOCK sqm varies
- DEEP SOIL AND LANDSCAPE

ROADS

STAIRS, RAMPS, AND LIFTS

LOADING DOCK

GARDEN BEDS
- WALKWAYS AND FOOTPATHS

POTENTIAL LANDSCAPE BATTER ZONE

PROPOSED TREE

FEATURE SCULPTURE

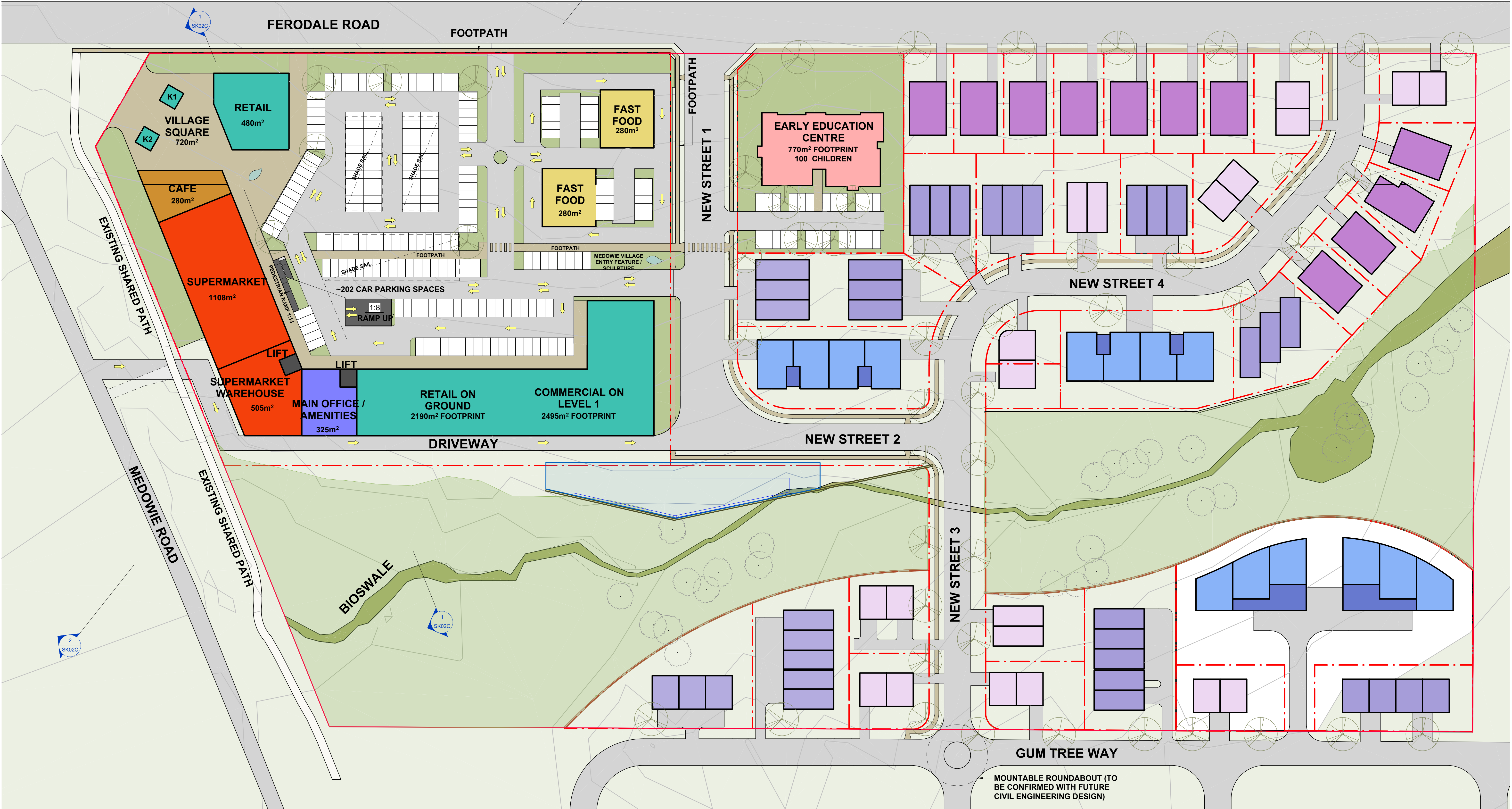

1 GROUND FLOOR

COMPLETION OF THE QA CHECKS IS VERIFICATION THAT THE DOCUMENT CONFORMS WITH THE REQUIREMENTS OF THE QUALITY PROJECT PLAN, WHERE THE QUALITY ASSURANCE CHECK IS INCOMPLETE THIS DOCUMENT IS PRELIMINARY FOR INFORMATION PURPOSES ONLY, OR SUCH PURPOSES AS STATED IN THE REVISION COLUMN. THE IDEAS, INFORMATION AND CONCEPTS CONTAINED IN THIS DOCUMENT ARE THE PROPERTY OF EJE. PHOTOCOPYING OR REPRODUCING THIS DOCUMENT AND PASSING IT ONTO OTHERS WITHOUT THE EXPRESS PERMISSION OF EJE IS AN INFRINGEMENT OF COPYRIGHT. ©

WORK IN FIGURED DIMENSIONS IN PREFERENCE TO SCALE. CHECK DIMENSIONS AND LEVELS ON SITE PRIOR TO THE ORDERING OF MATERIALS OR THE COMPLETION OF WORKSHOP DRAWINGS. IF IN DOUBT ASK. REPORT ALL ERRORS AND OMISSIONS.

ACN 002 912 843 | ABN 82 644 649 849 Nominated Architect - Bernard Collins NSW Architects Registration No 4438
A 412 KING STREET, NEWCASTLE, NSW, 2300 P +61 2 4928 2353 | F +61 2 4928 3069 | E mail@eje.com.au | W www.eje.com.au

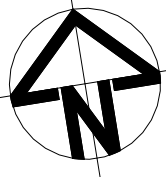

REV	DATE	COMMENTS	DRN	CHKD	VRFD
A	09/11/2024	MASTERPLAN - OPTION 2	CM	KG	
B	02/12/2024	MASTERPLAN REVISED	CM	KG	
C	17/01/2025	FLOOD EXTENTS REVISED	CM	KG	
D	02/05/2025	FOOTPATHS & INTERSECTION OPTIONS	CM	KG	
E	16/05/2025	RESPONSE TO COUNCIL RFI - 2025	MC	KG	

PROJECT: MEDOWIE VILLAGE DEVELOPMENT CLIENT: VC MANAGEMENT

46 TO 54 FERODALE ROAD,
MEDOWIE
WORIMI COUNTRY

DRAWING: GROUND FLOOR PLAN

DRAWN: DATE: SCALES: As indicated @ A1 1:200 @ A3

PROJECT No: 15563 PHASE: MP DRAWING No: SK02A REV: E



MEDOWIE COMMERCIAL VILLAGE MASTERPLAN

UNDERCROFT

LEGEND

- RETAIL AND COMMERCIAL

SUPERMARKET AND WAREHOUSE

AMENITIES AND VILLAGE OFFICE

FAST FOOD OUTLET

CAFE
- EARLY EDUCATION CENTRE

RESIDENTIAL 450 sqm²

DUAL OCCUPANCY 600 sqm²

TOWNHOUSES / VILLA sqm varies

APARTMENT BLOCK sqm varies
- DEEP SOIL AND LANDSCAPE

ROADS

STAIRS, RAMPS, AND LIFTS

LOADING DOCK

GARDEN BEDS
- WALKWAYS AND FOOTPATHS

POTENTIAL LANDSCAPE BATTER ZONE

PROPOSED TREE

FEATURE SCULPTURE

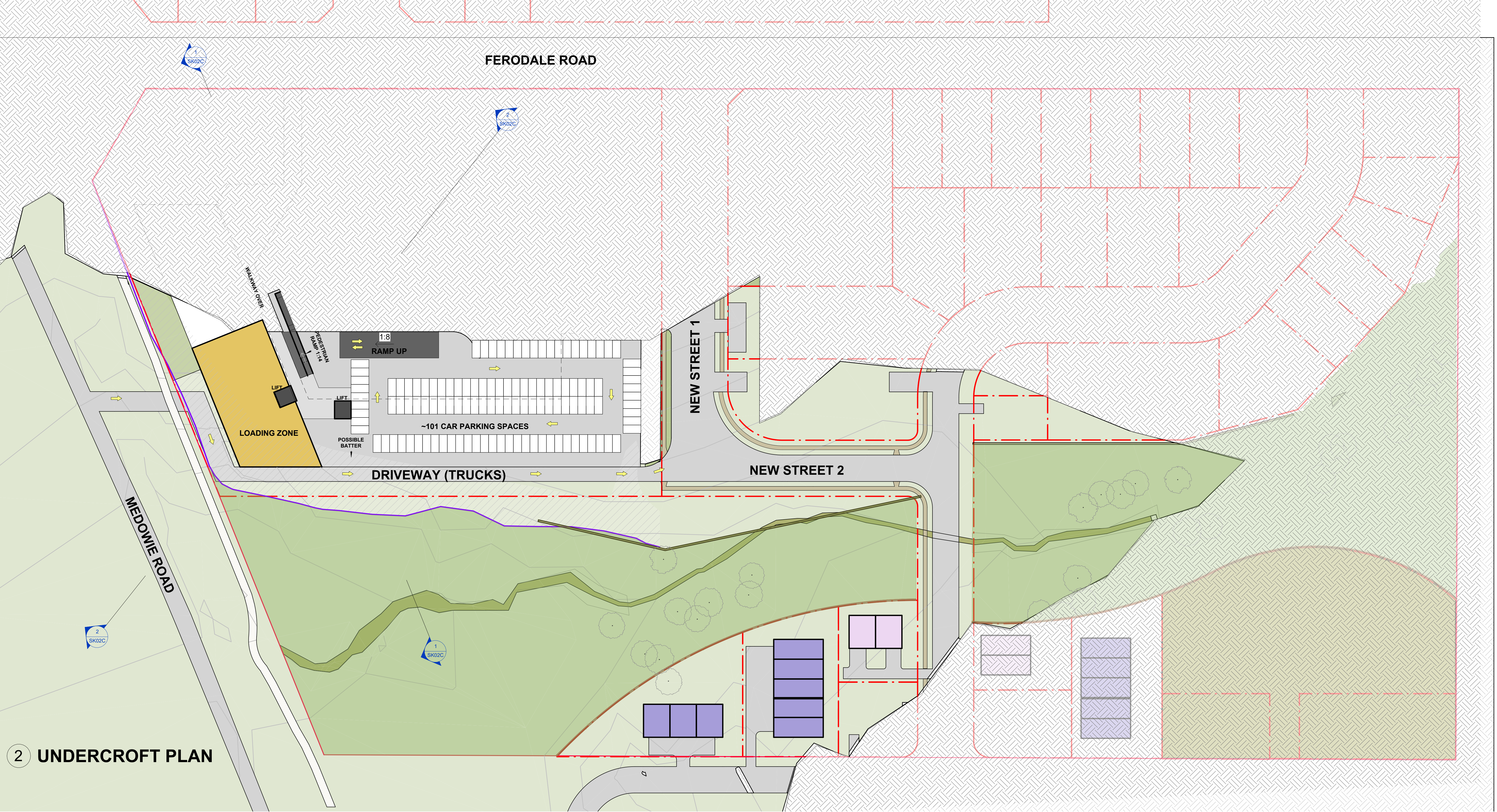

2 UNDERCROFT PLAN

COMPLETION OF THE QA CHECKS IS VERIFICATION THAT THE DOCUMENT CONFORMS WITH THE REQUIREMENTS OF THE QUALITY PROJECT PLAN, WHERE THE QUALITY ASSURANCE CHECK IS INCOMPLETE THIS DOCUMENT IS PRELIMINARY FOR INFORMATION PURPOSES ONLY, OR SUCH PURPOSES AS STATED IN THE REVISION COLUMN. THE IDEAS, INFORMATION AND CONCEPTS CONTAINED IN THIS DOCUMENT ARE THE PROPERTY OF EJE. PHOTOCOPYING OR REPRODUCING THIS DOCUMENT AND PASSING IT ONTO OTHERS WITHOUT THE EXPRESS PERMISSION OF EJE IS AN INFRINGEMENT OF COPYRIGHT ©

WORK IN FIGURED DIMENSIONS IN PREFERENCE TO SCALE. CHECK DIMENSIONS AND LEVELS ON SITE PRIOR TO THE ORDERING OF MATERIALS OR THE COMPLETION OF WORKSHOP DRAWINGS. IF IN DOUBT ASK. REPORT ALL ERRORS AND OMISSIONS.

ACN 002 912 843 | ABN 82 644 649 849 Nominated Architect - Bernard Collins NSW Architects Registration No. 4438
A 412 KING STREET, NEWCASTLE, NSW, 2300 P +61 2 4929 2353 | F +61 2 4926 3069 | E mail@eje.com.au | W www.eje.com.au

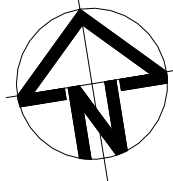

REV	DATE	COMMENTS
A	09/11/2024	MASTERPLAN - OPTION 2
B	02/12/2024	MASTERPLAN REVISED
C	20/01/2025	FLOOD EXTENTS - UNDERCROFT
D	16/05/2025	RESPONSE TO COUNCIL RFI - 2025

DRN	CHKD	VRFD
CM	KG	
CM	KG	
MC	KG	

PROJECT: MEDOWIE VILLAGE DEVELOPMENT CLIENT: VC MANAGEMENT

46 TO 54 FERODALE ROAD,
MEDOWIE
WORIMI COUNTRY

DRAWING: UNDERCROFT PLAN

DRAWN: DATE: SCALES:

As indicated @ A1
1 : 200 @ A3

PROJECT No: 15563 PHASE: MP DRAWING No: SK02B REV: D



MEDOWIE COMMERICAL VILLAGE DEVELOPMENT

SECTIONS

LEGEND

- RETAIL AND COMMERCIAL

SUPERMARKET AND WAREHOUSE

AMENITIES AND VILLAGE OFFICE

FAST FOOD OUTLET

CAFE
- EARLY EDUCATION CENTRE

RESIDENTIAL 450 sqm²

DUAL OCCUPANCY 600 sqm²

TOWNHOUSES / VILLA sqm varies

APARTMENT BLOCK sqm varies
- DEEP SOIL AND LANDSCAPE

ROADS

STAIRS, RAMPS, AND LIFTS

LOADING DOCK

GARDEN BEDS
- WALKWAYS AND FOOTPATHS

POTENTIAL LANDSCAPE BATTER ZONE

PROPOSED TREE

FEATURE SCULPTURE

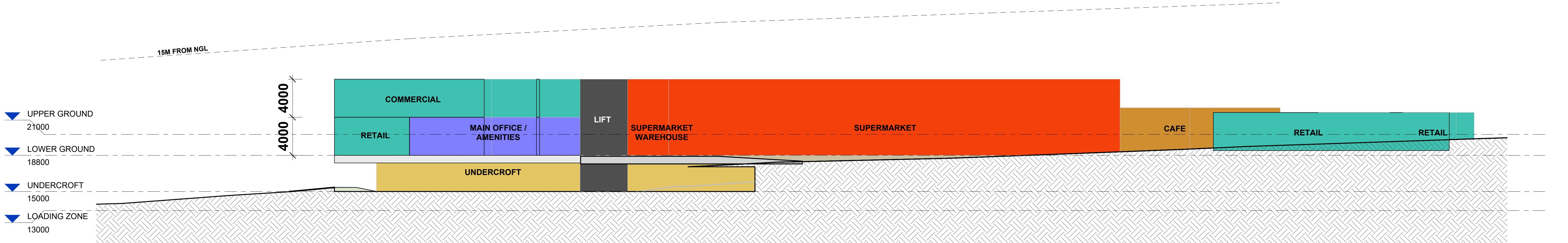

1 SECTION 1

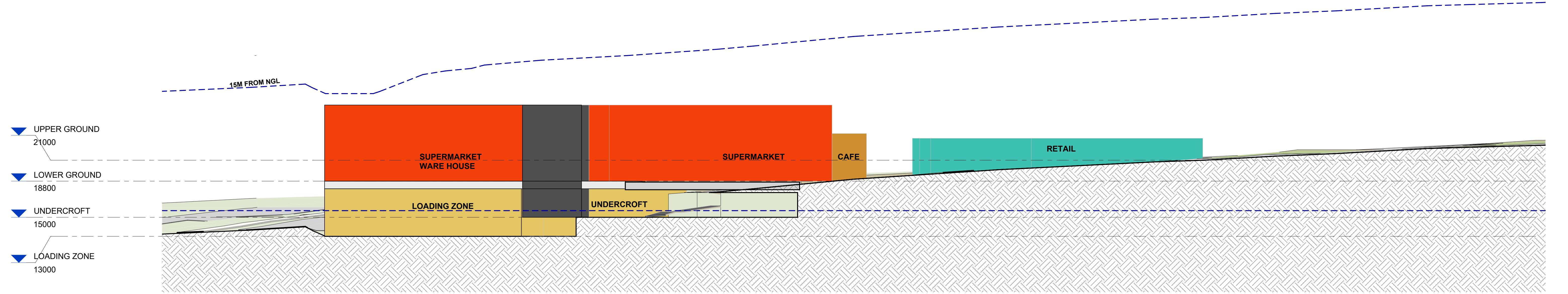

2 SECTION 2

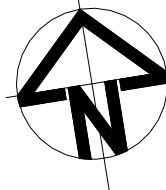

REV	DATE	COMMENTS
A	09/11/2024	MASTERPLAN - OPTION 2
B	16/05/2025	RESPONSE TO COUNCIL RFI - 2025

DRN	CHKD	VRFD
CM	KG	
MC	KG	

PROJECT: **MEDOWIE VILLAGE DEVELOPMENT** CLIENT: **VC MANAGEMENT**

**46 TO 54 FERODALE ROAD,
MEDOWIE
WORIMI COUNTRY**

DRAWING: **SECTIONS**

DRAWN: DATE: SCALES: **As indicated@ A1
1 : 200@ A3**

PROJECT No: **15563** PHASE: **MP** DRAWING No: **SK02C** REV: **B**



MEDOWIE COMMERICAL VILLAGE DEVELOPMENT

PERSPECTIVES

LEGEND

- RETAIL AND COMMERCIAL

SUPERMARKET AND WAREHOUSE

AMENITIES AND VILLAGE OFFICE

FAST FOOD OUTLET

CAFE
- EARLY EDUCATION CENTRE

RESIDENTIAL 450 sqm²

DUAL OCCUPANCY 600 sqm²

TOWNHOUSES / VILLA sqm varies

APARTMENT BLOCK sqm varies
- DEEP SOIL AND LANDSCAPE

ROADS

STAIRS, RAMPS, AND LIFTS

LOADING DOCK

GARDEN BEDS
- WALKWAYS AND FOOTPATHS

POTENTIAL LANDSCAPE BATTER ZONE

PROPOSED TREE

FEATURE SCULPTURE

1 VIEW 1 - FROM NORTH

2 VIEW 2 - FROM SOUTH

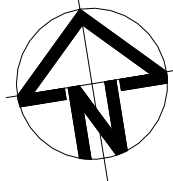

REV	DATE	COMMENTS
A	09/11/2024	MASTERPLAN - OPTION 2
B	16/05/2025	RESPONSE TO COUNCIL RFI - 2025

DRN	CHKD	VRFD
CM	KG	
MC	KG	

PROJECT: **MEDOWIE VILLAGE DEVELOPMENT** CLIENT: **VC MANAGEMENT**

**46 TO 54 FERODALE ROAD,
MEDOWIE
WORIMI COUNTRY**

DRAWING: **PERSPECTIVE**

DRAWN: DATE: SCALES:
1: 800@A1
1: 200@A3

PROJECT No: **15563** PHASE: **MP** DRAWING No: **SK02D** REV: **B**



MEDOWIE COMMERICAL VILLAGE DEVELOPMENT

FOOTPATH PLAN

LEGEND

EXISTING SHARED PATH

NEW FOOTPATH

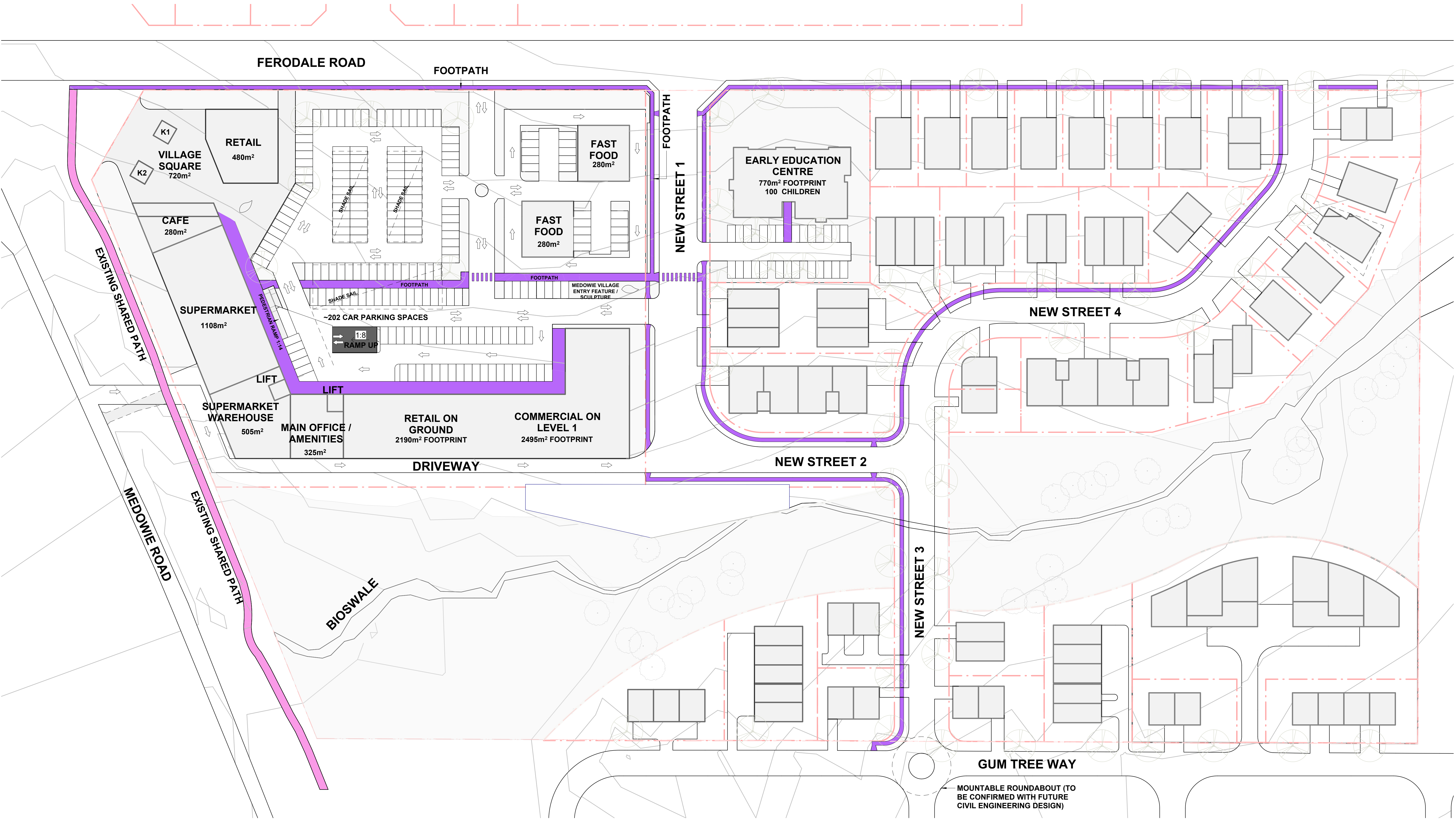

1 GROUND FLOOR

COMPLETION OF THE QA CHECKS IS VERIFICATION THAT THE DOCUMENT CONFORMS WITH THE REQUIREMENTS OF THE QUALITY PROJECT PLAN, WHERE THE QUALITY ASSURANCE CHECK IS INCOMPLETE THIS DOCUMENT IS PRELIMINARY FOR INFORMATION PURPOSES ONLY, OR SUCH PURPOSES AS STATED IN THE REVISION COLUMN. THE IDEAS, INFORMATION AND CONCEPTS CONTAINED IN THIS DOCUMENT ARE THE PROPERTY OF EJE. PHOTOCOPYING OR REPRODUCING THIS DOCUMENT AND PASSING IT ONTO OTHERS WITHOUT THE EXPRESS PERMISSION OF EJE IS AN INFRINGEMENT OF COPYRIGHT. ©

WORK IN FIGURED DIMENSIONS IN PREFERENCE TO SCALE. CHECK DIMENSIONS AND LEVELS ON SITE PRIOR TO THE ORDERING OF MATERIALS OR THE COMPLETION OF WORKSHOP DRAWINGS. IF IN DOUBT ASK. REPORT ALL ERRORS AND OMISSIONS.

ACN 002 912 843 | ABN 82 644 649 849 Nominated Architect - Bernard Collins NSW Architects Registration No 4438
A 412 KING STREET, NEWCASTLE, NSW, 2300 P +61 2 4929 2353 | F +61 2 4926 3069 | E mail@eje.com.au | W www.eje.com.au

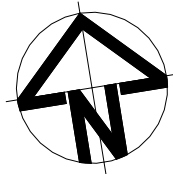

REV	DATE	COMMENTS
A	16/05/2025	RESPONSE TO COUNCIL RFI - 2025

DRN	CHKD	VRFD
MC	KG	

PROJECT: MEDOWIE VILLAGE DEVELOPMENT CLIENT: VC MANAGEMENT

46 TO 54 FERODALE ROAD,
MEDOWIE
WORIMI COUNTRY

DRAWING: FOOTPATH PLAN

DRAWN:	DATE:	SCALES:
MC	05/16/25	As indicated@A1 @A3

PROJECT No:	PHASE:	DRAWING No:	REV:
15563	MP	SK02E	A

